

# University of Portland

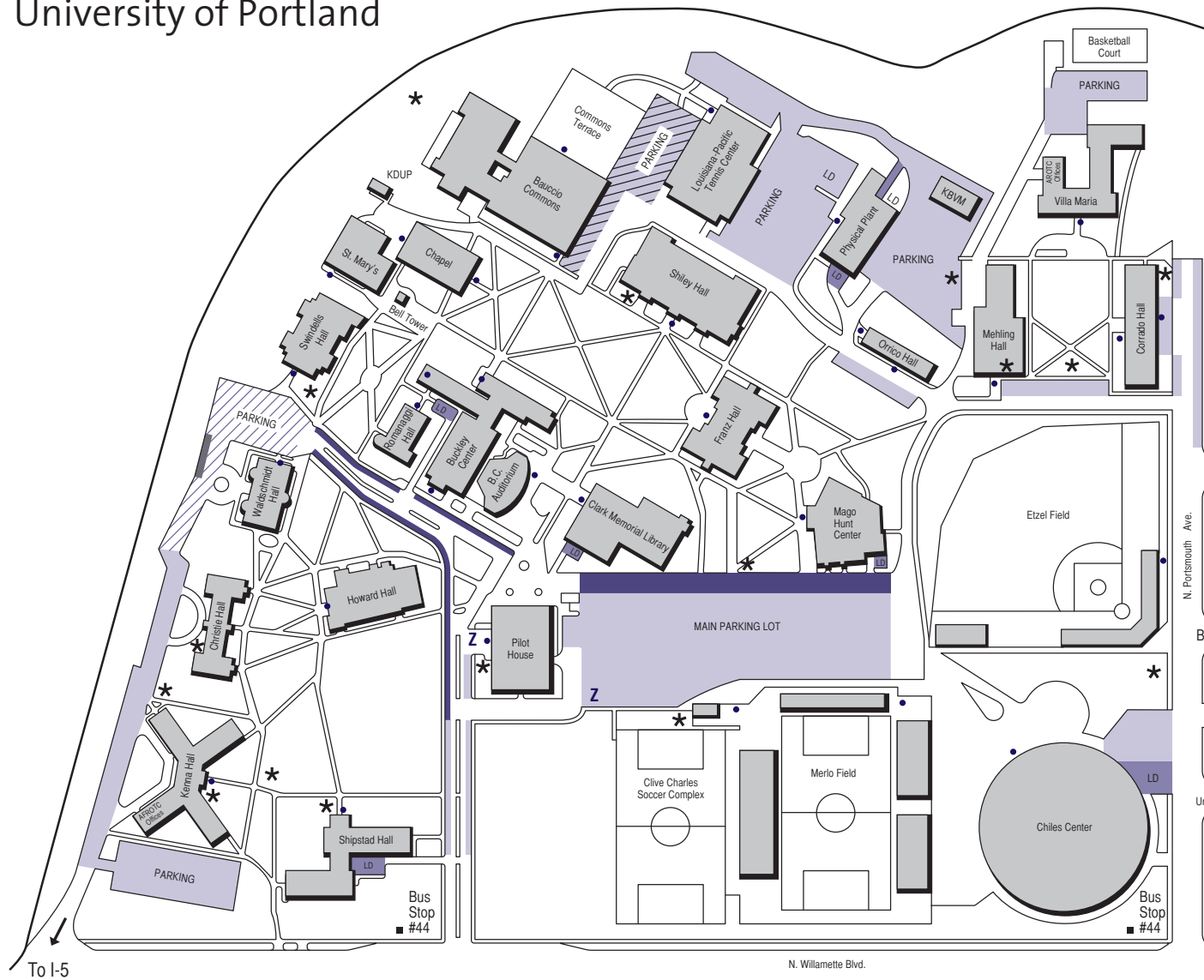

Parking permits required Monday - Friday, 8 a.m. - 4 p.m.

- Admission Visitor Parking
- General - Students, Faculty and Staff with permits; Visitors with parking passes; Event parking
- ▨ Faculty and Staff with permits; Visitors with parking passes
- Carpool - With Carpool Permit Only
- Loading Dock (LD)
- ▨ RESERVED - Parking only with "W" permit 24 hours a day, all year
- ▣ Secure Garage Parking in Haggerty Hall and Tyson Hall
- Wheelchair Accessible Entrances
- ★ Emergency Telephones
- Z Zipcar Location

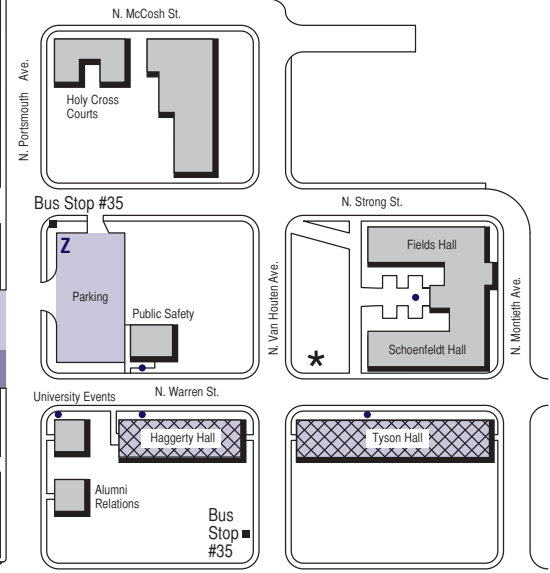

MAP B 6-30-11

## Alumni Relations

- Bauccio Commons** - student-faculty dining hall; Terrace Room; Bon Appétit; Teske Room, Board Room
- Bell Tower**
- Buckley Center** - Center for Entrepreneurship; College of Arts and Sciences; Garaventa Center; School of Nursing; Shepard Freshman Resource Center; information services; mail center; printing services; residence life; classrooms
- Chapel of Christ the Teacher** - campus ministry
- Chiles Center** - convocation and athletic center; athletic office
- Christie Hall** - men's residence; international student services

## Clark Memorial Library

- Clive Charles Soccer Complex** - Merlo Field; practice fields
- Corrado Hall** - men's and women's residence
- Etzel Field** - baseball field; Andy Pienovi hitting facility
- Fields Hall** - women's residence
- Franz Hall** - Dr. Robert B. Pamplin, Jr. School of Business Administration; School of Education; classrooms; computer labs; Learning Resource Center
- Haggerty Hall** - men's and women's residence
- Holy Cross Court** - priests' residence
- Howard Hall** - recreation center; swimming pool
- KBVM** - Catholic radio station

## KDUP - campus radio station

- Kenna Hall** - men's and women's residence; Air Force ROTC; campus ministry outreach, Saturday Academy
- Louisiana-Pacific Tennis Center**
- Mago Hunt Center** - theater and recital hall
- Mehling Hall** - women's residence
- Orrico Hall** - career services; health center
- Physical Plant**
- Pilot House** - bookstore; The Cove; campus ministry outreach; campus information center; student lounge
- Public Safety**
- Romanaggi Hall** - classrooms; laboratories
- Schoenfeldt Hall** - men's residence

## Shiley Hall - Donald P. Shiley School of Engineering; classrooms

- Shipstad Hall** - men's and women's residence; archives; museum
- St. Mary's Student Center** - ASUP; The Beacon; The Log; student activities; Moreau Center for Service and Leadership
- Swindells Hall** - classrooms; laboratories
- Tyson Hall** - men's and women's residence
- University Events**
- Villa Maria Hall** - men's residence; Army ROTC
- Waldschmidt Hall** - admissions; cashier; controller; development; executive officers; financial aid; Graduate School; personnel; marketing; registrar; student accounts